

# bizhub 4752/bizhub 4052 INSTALLATION MANUAL

KONICA MINOLTA, INC.

Applied Machines: **bizhub 4752/bizhub 4052**

<Important>

*Be sure to correctly follow the procedures in order as explained in this Installation Manual.  
If you do not follow the procedure in order, the image trouble may occur.*

## 1. Outline of installation procedures

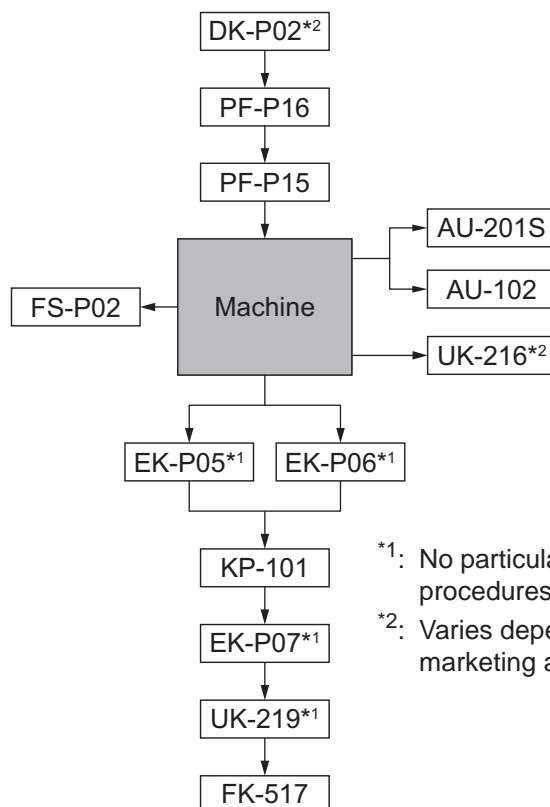

\*1: No particular order in installation procedures

\*2: Varies depending on the applicable marketing area

When installing the machine and associated options as a system, follow the order shown on the upper.

### Note:

- For the detailed installation procedures for each option, follow the instructions given in the corresponding installation manual and perform the procedures correctly.
- Once the Power Switch is turned ON, do not turn OFF it until the installation work has been completed.

### Caution:

- Lifting the machine in an awkward position or transporting it in a poorly balanced position could result in personal injury. When transporting the machine, assign an adequate number of persons to the job and ensure that each person can take a good position of not being excessively loaded (mass: approx. 24.4 kg (53-13/16 lb))



PUB1041-001

## 2. Installation space

To make it easier to control, replace the consumables, inspect, and etc., maintain some space for installation shown below.

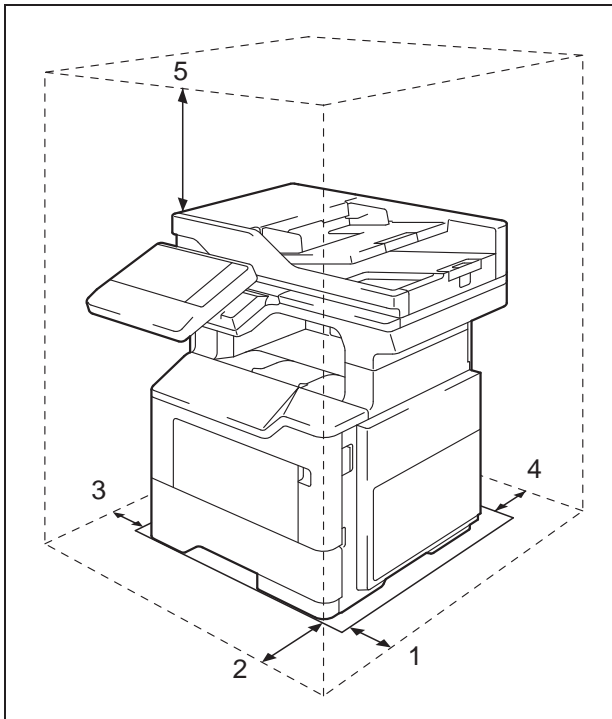

No.	Direction	Space to maintain
1	Right	110 mm (4-5/16 inches)
2	Front	304.8 mm (12 inches)
3	Left	65 mm (2-9/16 inches)
4	Rear	100 mm (3-15/16 inches) When the optional Finisher FS-P02 is mounted: 270 mm (10-5/8 inches)
5	Top	305 mm (12 inches)

## 3. Pre-installation check items

- (1) Select a level and stable place for installing the machine.
- (2) Be sure to use a power source of the voltage and frequency indicated in the product specifications. Ensure that the current carrying capacity of the power outlet is at least equal to the current listed in the product specifications.
- (3) Power the machine directly from a dedicated power outlet. (Do not use an extension cord.)
- (4) Do not plug or unplug the power cord with wet or dirty hands, otherwise you may get an electric shock.
- (5) Avoid a hot and humid environment, or a place exposed to direct sunlight.
- (6) Avoid a dusty location, or a place near volatile and flammable substances.
- (7) Avoid a poorly ventilated place.

## 4. Notes on using touch panel

Be sure to instruct users on the following points.

- This machine uses a capacitive touch panel. When you touch the touch panel, use your finger or the stylus pen for the capacitive touch panel. If you touch the panel using your nail or a pen tip instead of using your finger or the stylus pen, the touch panel does not respond normally.
- Pressing the touch panel hard may cause damage.
- Do not strongly press the panel or press it using the sharp tip of mechanical pencils.
- The key is a finger tapping (quick light touch using a finger) operation.

## 5. Accessory parts

No.	Name	Q'ty
1.	Quick start guide	1
2.	Installation manual	1 set
3.	User's guide CD	1
4.	DVD	1
5.	Panel sheet	1
6.	Power cord *	1

\* Varies depending on the applicable marketing area

### WARNING



Keep this bag away from babies and children. Do not use in cribs, beds, carriages, or playpens.



The thin film may cling to nose and mouth and prevent breathing. This bag is not a toy.

### WARNING



If a power cord is not supplied, use only the power cord that meets the following conditions.

Failure to do this could result in a fire or electrical shock.

- The power cord has voltage and current rating appropriate for the rating plate on this machine.
- The power cord meets regulatory requirements for the area.
- The power cord is provided with grounding pin/terminal.

\* Power supply: 110-127V 8.2A, 220-240V 4.2A

#### Note:

This manual provides the illustrations of the accessory parts and machine that may be slightly different in shape from yours. In that case, instead of the illustrations, use the appearance of your machine to follow the installation procedure. This does not cause any significant change or problem with the procedure.

## 6. Unpacking the machine

- (1) Open the packing carton and remove the accessory parts and cushions.
- (2) Raise and remove the packing carton.
- (3) Assign two or more persons and put their hands at the positions indicated in the illustration to raise the machine from the box, and place the machine on the horizontal and robust place.

### CAUTION

Be sure to hold the place specified in the User's Guide or other manuals to transfer the machine.



Holding other places than the specified in transferring the machine could cause personal injury due to the drop of the machine or other reasons.

(Machine mass: approx. 24.4 kg (53-13/16 lb))

< When taking the machine out of the carton >

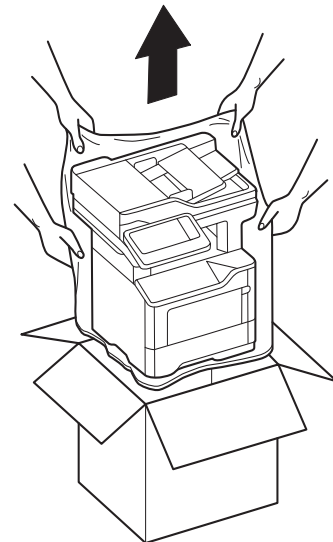

<When transferring the machine after being installed>

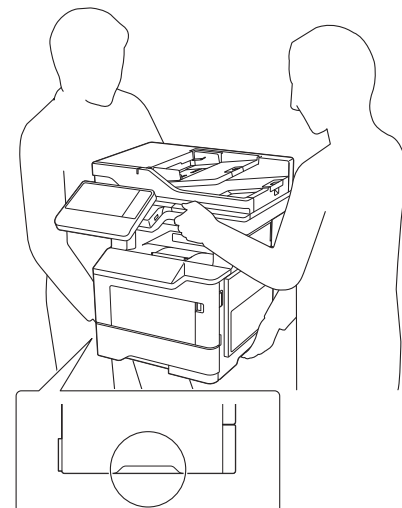

## 7. Removing protective tape, packing and other shipping materials

- (1) Remove tapes for protective sheet and get rid of the protective sheet.
- (2) Remove all protective tapes and protective materials used for fixing the machine housing.

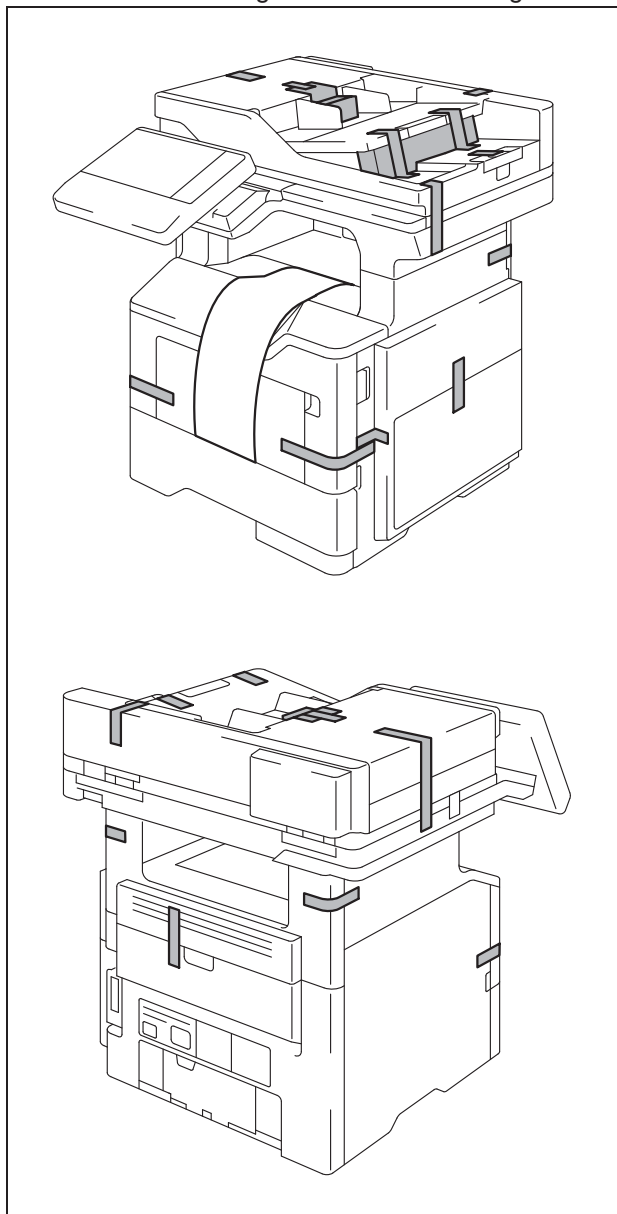

- (3) Open the automatic document feeder (ADF) and remove the protective tape and protective material.

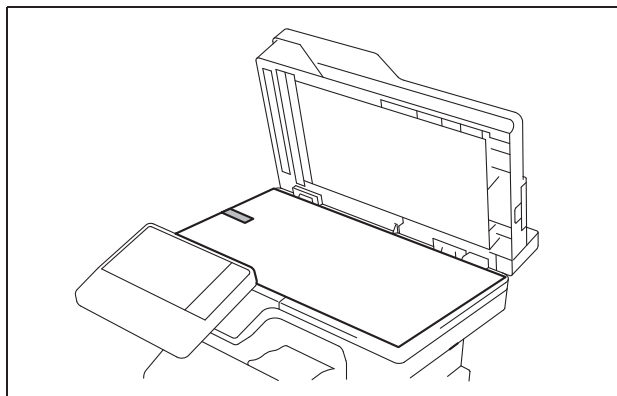

- (4) Press the front door button to open the front door.

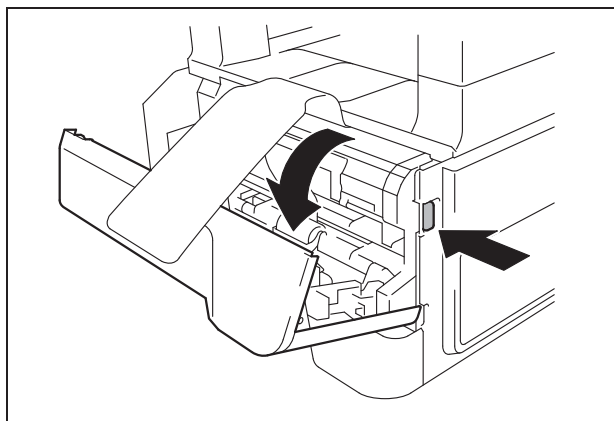

- (5) Hold the handle and slowly pull out the toner cartridge.

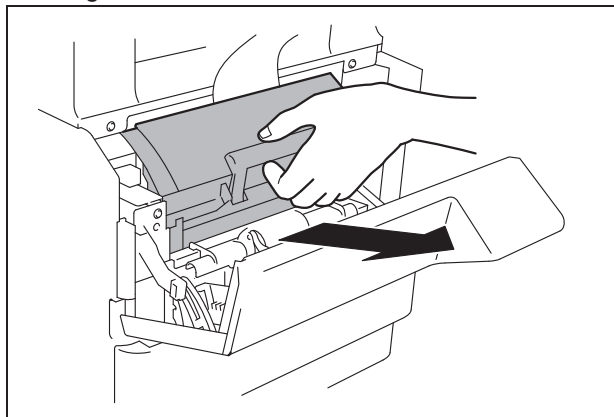

- (6) Hold the handle and slowly pull out the imaging unit.

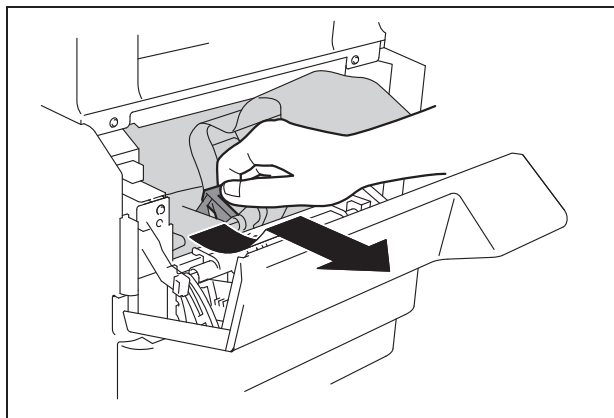

(7) Shake the imaging unit from front to back and from side to side.

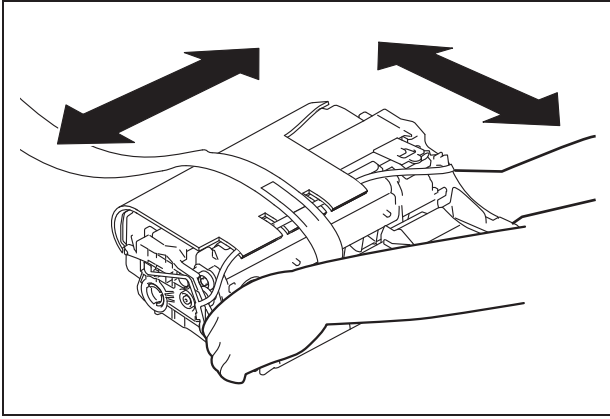

(8) Remove the protective materials from the imaging unit.

**Note:**

Do not touch the photo conductor.

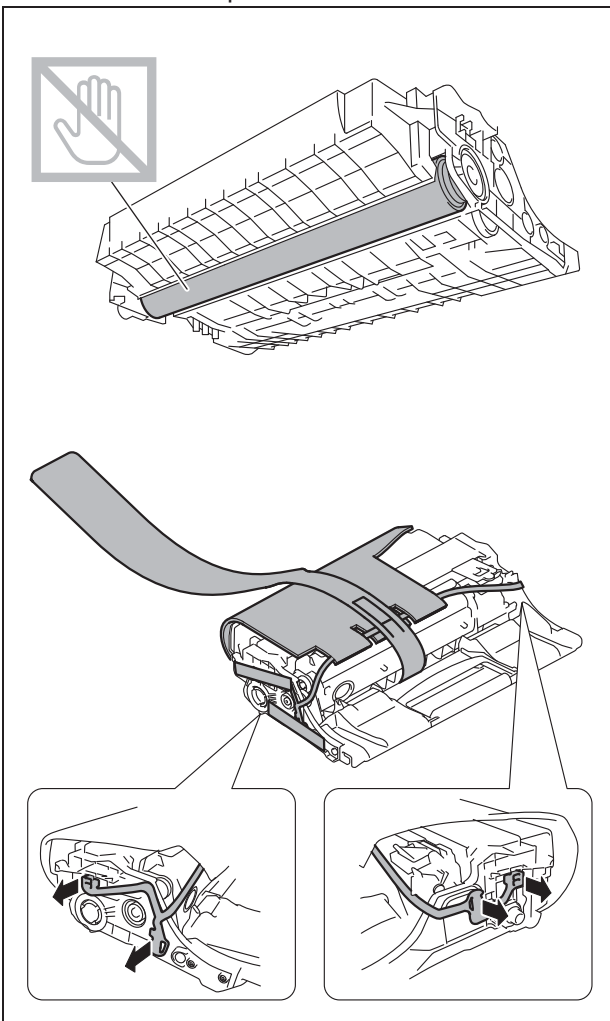

(9) Reinstall the imaging unit.

**Note:**

Align the arrows on the imaging unit with the arrows on the machine.

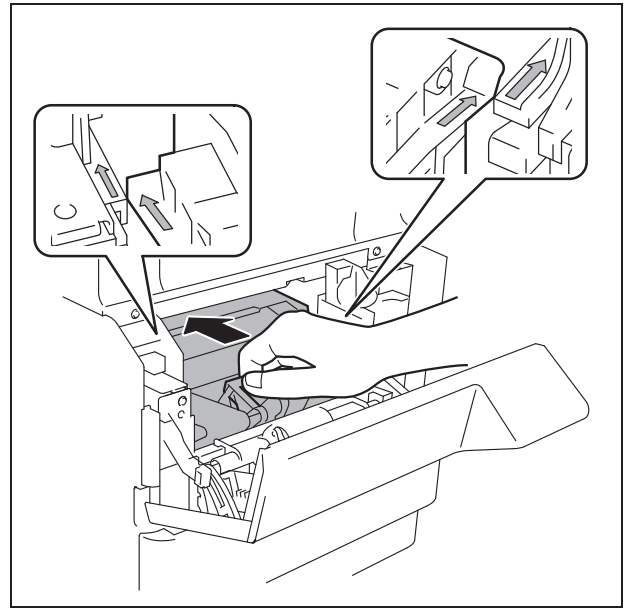

(10) Hold the handle and shake the toner cartridge from front to back and from side to side.

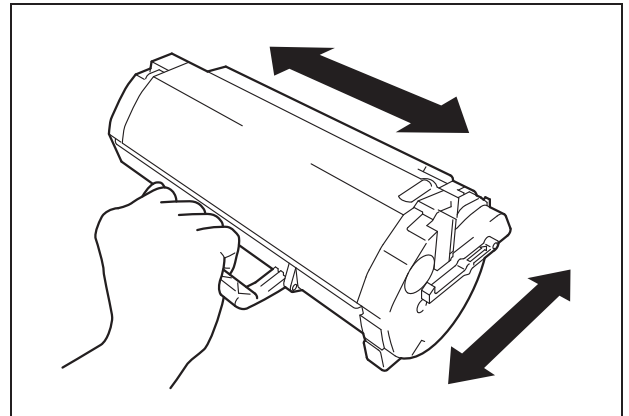

(11) Reinstall the toner cartridge.

**Note:**

Align the arrows on the toner cartridge with the arrows on the machine

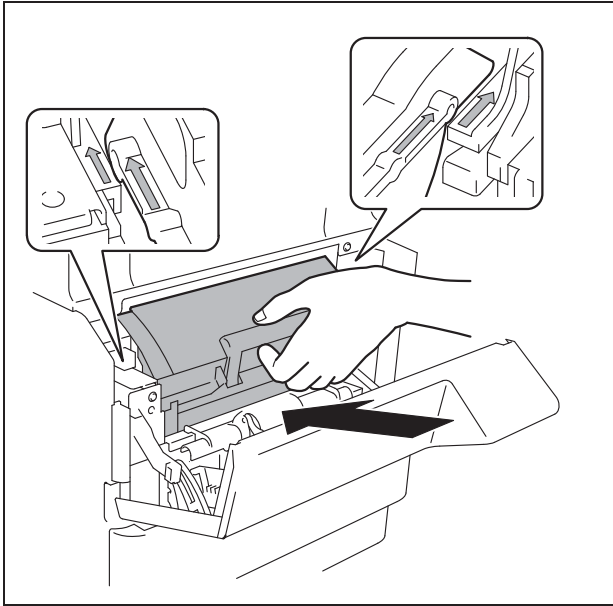

(12) Close the front door.

(13) Slide out the tray 1 and remove the protective materials from the inside of the tray.

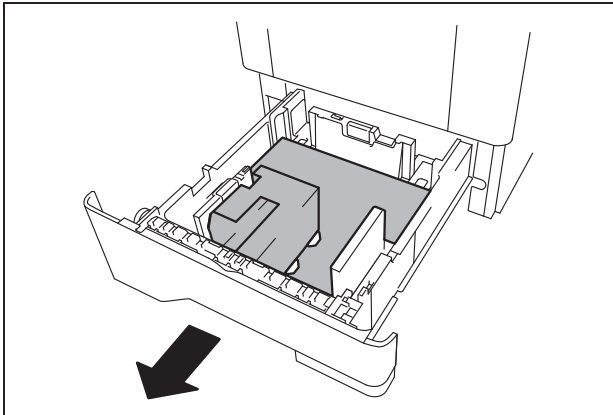

## 8. Loading the tray 1

(1) Slide the paper guides to the appropriate paper size.

(2) Fix the paper guide.

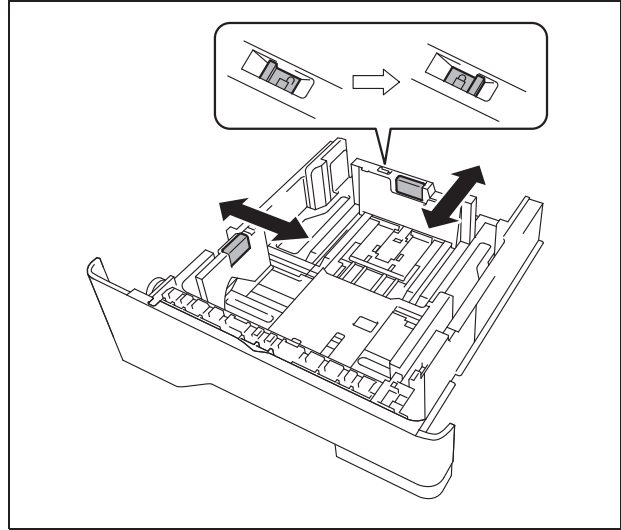

(3) Set paper with the printing side downward.

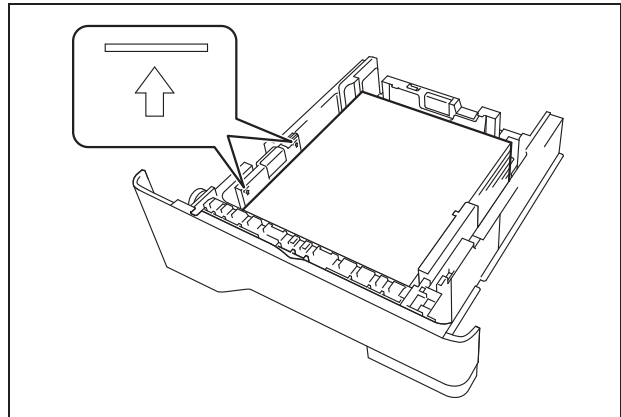

(4) Reinstall the tray 1.

(5) Slide out the exit guide.

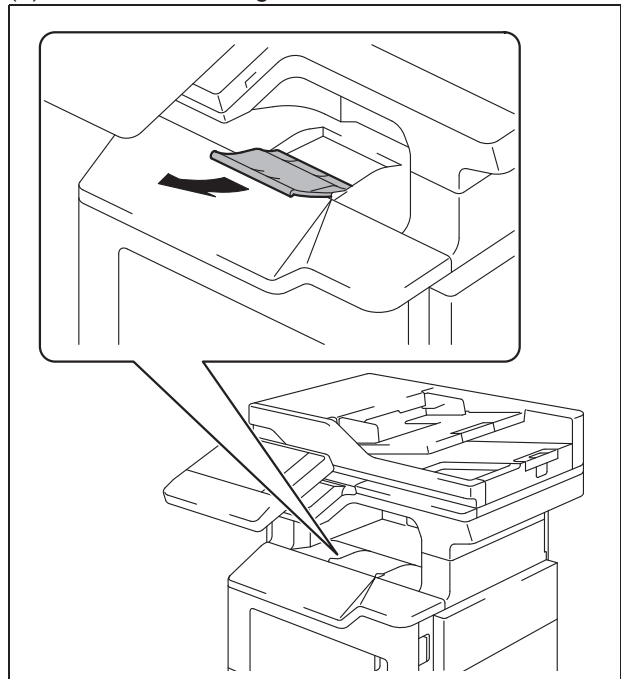

## 2. Starting procedure

### NOTE

- Ensure appropriate security for Service Mode function setting procedures. They should NEVER be shown to any unauthorized person not involved with service jobs.

### 2.1 Procedure

1. Touch Menu.
2. Touch [Counter].
3. Touch [Display Keypad].
4. Press the following keys in this order.
  - Stop -> 0 -> 0 -> Stop -> 0 -> 1
5. Enter the CE password and touch [END]. (The CE password is initially set to "9272927292729272.")

#### NOTE

- When [Administrator Settings] -> [Security Settings] -> [Enhanced Security Mode] is set to "ON", CE password authentication is necessary.
  - If a wrong CE password is entered, re-enter the right password.  
The machine will not enter Service Mode unless the CE password is entered correctly. To return to the basic screen, turn OFF the main power switch and turn it ON again.
  - When [Administrator Settings] -> [Security Settings] -> [Security Details] -> [Prohibited Functions When Authentication Error] is set to "Mode 2", operation will be prohibited since it indicates authentication failure by failing to enter the correct CE password within the specified number of times.  
If the access lock is activated, the lock release timer starts to operate by input the Stop -> 0 -> 9 -> 3 -> 1 -> 7 in Menu -> [Counter] -> [Print List] -> [Display Keypad] after the main power switch is turned OFF and On.  
When the timer reaches the time specified in this setting, the access lock is released.
  - The service code entered is displayed as "\*" "
6. The Service Mode menu will appear.

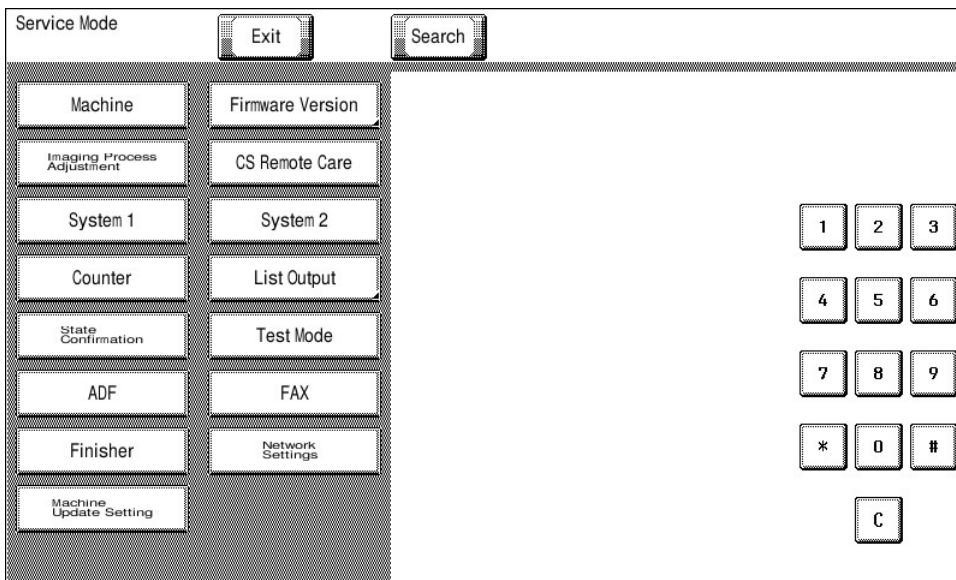

#### NOTE

- Be sure to change the CE password from its default value.
- For the procedure to change the CE password, see the [Enhanced Security] -> [CE Password].
- NEVER forget the CE password.



### 3. Setting procedure

1. Press the key corresponding to the function you would like to change the setting for. Keys or setting screens will appear for each function.  
Ex.: System 1

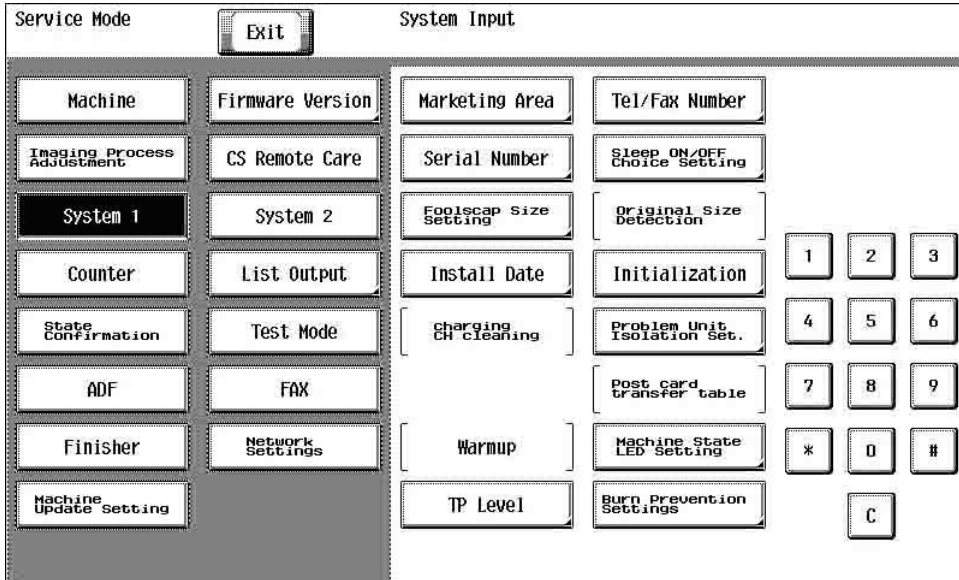

1. Press the key for the item that you would like to change the setting for. Setting screens will appear for each item.  
Ex.: Install Date

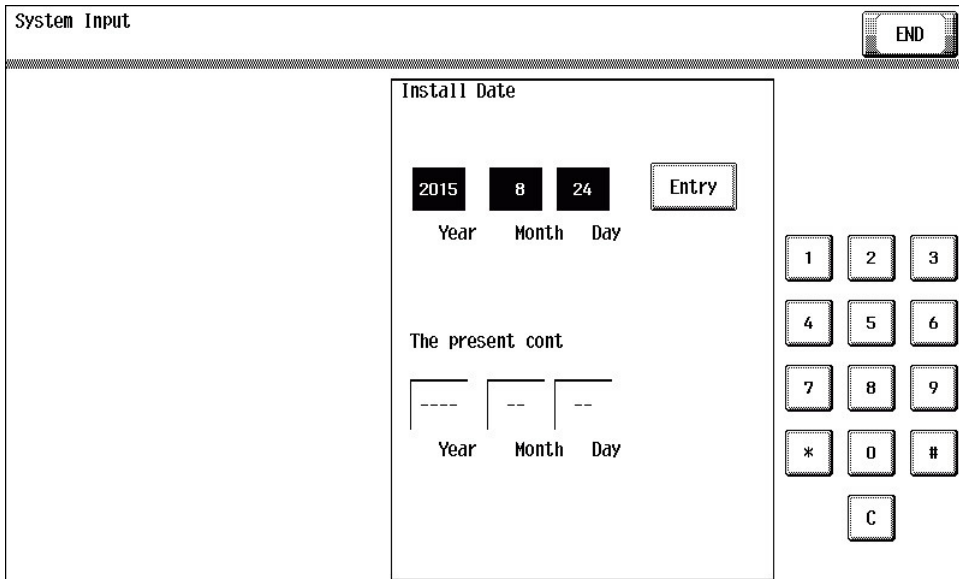

2. Press the key for the setting you would like to change. You can also input the numerical value using the 10-key pad. (the [+]/[-] keys can also be used for settings. Follow the directions on the screen to input numerical values.)

**NOTE**

- For more details, see the description pages for each setting item.

3. Touch [END]. This closes the setting screen and returns to the Service Mode screen. (If deep within the hierarchy of the setting screen, it may be necessary to touch [END] several times)
4. Touch [Exit]. This will close the Service Mode screen and exit the Service Mode.
5. Turn OFF the main power switch. After waiting 10 seconds, turn ON the main power switch again. Turning the main power switch OFF and then ON again makes the changes to the Service Mode setting take effect.

**NOTE**

- Simply exiting the Service Mode will not make the changed settings take effect. You must turn the main power switch OFF and then ON again.



## 4. Exiting procedure

1. Touch [Exit] on the Service Mode screen.
2. Turn OFF the main power switch. Wait 10 seconds, then turn ON the main power switch again.

## 9. Installing options

To install options, refer to the installation manual for each option and follow the "Installation Procedures."

## 10. Connecting the power cord

- (1) Connect the plug of the power cord into the main body.

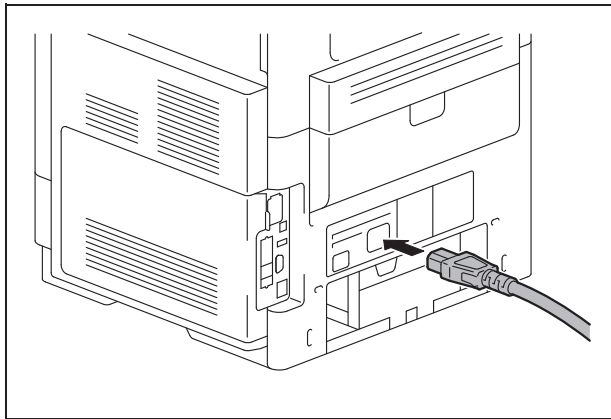

- (2) Plug the power cord into the power outlet.

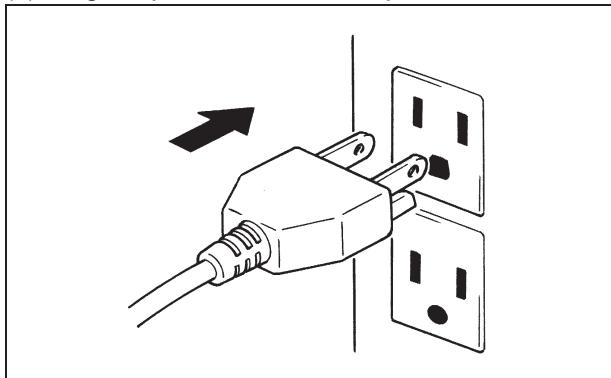

## 11. Starting the machine

Turn ON the power switch on the rear of the main body.

## 12. Date & Time Setting/Time Zone Setting (Service Mode)

- (1) Display the Service Mode screen.  
(For details of how to display the Service Mode screen, see the service manual.)
- (2) Display the Date & Time Setting/Time Zone Setting screen.  
(To display the Date & Time Setting/Time Zone Setting screen, press Stop → 3 on the control panel.)
- (3) Do not input date and time but touch "Entry" of the Date & Time Setting.
- (4) Input the time zone using up/down keys or direct keys.
- (5) Touch "Entry" of the Time Zone Setting.
- (6) Touch "Apply."
- (7) Touch "OK."
- (8) Touch "Next."

## 13. Serial number input

### Note:

Serial number input is, if necessary, needed only for the optional devices installed in "9. Installing options."

- (1) Touch the item you want to enter and input the serial number.
- (2) Touch "END."
- (3) For other devices, enter their serial number in the same way.
- (4) Touch "END."
- (5) Touch "Next."

## 14. Unit change

### Note:

This function allows the user to select the type of message that will appear when the replacement time arrives for each of the different units.

- (1) Select the appropriate message type for each unit.
- (2) Touch "Service."

## 15. Performing Non-Image Area Erase Check

### Note:

Perform the below at the site where customer uses the machine.

- (1) Select the Non-Image Area Erase Check function as follows:  
Machine → Non-Image Area Erase Check.
- (2) Open fully the ADF.

### Note:

- Do NOT place a document on the document glass.
- Clean the document glass if dirty.

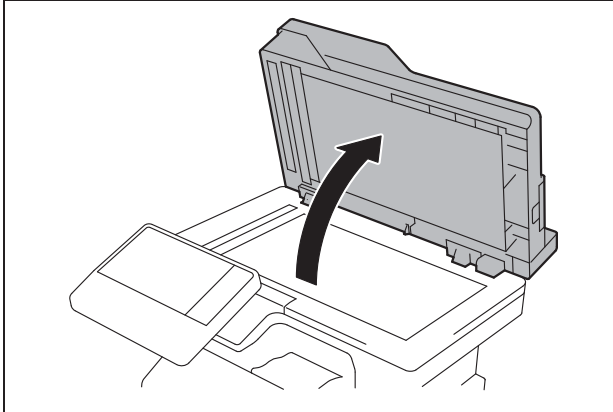

- (3) Press the Start key.
- (4) Make sure that "Result" is "OK."

### Note:

If "Result" is "NG1" or "NG2", review the place and direction of installation, or take measures to block the light source (by covering it, etc.), then perform installation checking again.

(If a fluorescent light or other bright light sources exist right above the machine, the light source can hinder installation checking and cause operation errors in the Non-Image Area Erase Check. For detailed information, see the service manual.)

- (5) Touch "OK."

## 16. Configuring options



- (1) If any of the following options are installed, refer to the "Configuration procedures" of the installation manual for each option and configure the option(s).
  - Authentication Unit AU-201S/AU-102
  - Upgrade Kit UK-216
  - Fax Kit FK-517
  - Local Interface Kit EK-P06
  - Network Fax
- (2) Exit from the Service Mode and return to the initial screen.

## 17. Setting up wireless connection kit (only for North America models)

- (1) Display the Service Mode screen.  
(For details of how to display the Service Mode screen, see the service manual.)
- (2) Touch "Network Settings."
- (3) Touch "2nd Network Setting."
- (4) Touch "Network Interface Settings."
- (5) Select the appropriate option according to the user's network environment.
- (6) Touch "Fix."
- (7) Turn OFF and ON the power switch.

### Note:

When displayed the Service Mode screen, be sure to turn off the power after exiting the Service Mode screen and wait for 10 seconds or more before turning on.

- (8) Display the Service Mode screen.
- (9) Touch "System 1."
- (10) Touch "Marketing Area."
- (11) Touch "Wireless LAN Destination."
- (12) Use the  or  key to select "US" and touch "decision."

## 18. Restarting the machine

Turn the power switch on the rear of the main body OFF and ON again after 10 or more seconds have passed.

## 19. Connecting the network cable

- (1) Connect the main body and networking equipment (HUB) using the network cable.

**Note:**

The following shows the recommended network cables that correspond to each communication speed.

- 10BaseT/100BaseTX: Category 5
- 1000BaseT: Category 5E, Category 6

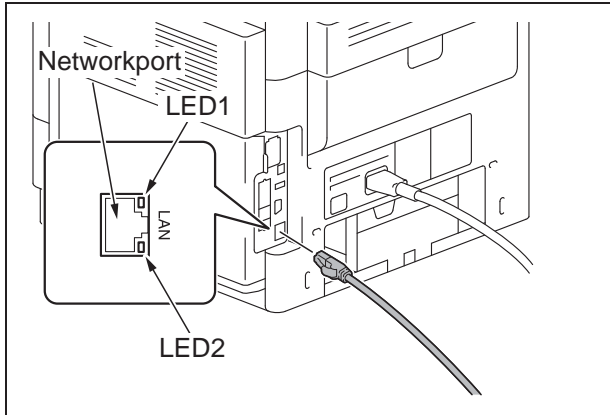

- (2) Check LEDs for lighting conditions.

LED1:

Should light up steadily if the link network connection has been made.

LED2:

Should blink according to the communications status of the ACT network.

## 20. Network setting

Make the TCP/IP address setting for the network.

**Note:**

Consult the network administrator for the setting value to be entered and make settings as required.

- (1) Select the function to be used as follows:  
Menu → Utility → Administrator Settings → Enter the Administrator Password → Network Settings → TCP/IP Settings → IPv4 Settings.
- (2) Touch "Manual Input" of IP Application Method and make the following settings.  
IP Address: IP address of the controller  
Subnet Mask: Subnet mask of the network, to which the machine is connected  
Default Gateway: IP address of the default gateway
- (3) Touch "OK."
- (4) Touch "OK" after the "TCP/IP Settings" screen is displayed.
- (5) Select the function to be used as follows:  
Forward → Detail Settings → PING Confirmation, and make the operation check of TCP/IP.

## 21. Confirming the copy sample

After completing all the steps, take a sample copy and confirm the image. If image troubles occur, first turn OFF and ON the Main Power Switch, and then redo the steps from E-7 "12. Date & Time Setting/ Time Zone Setting (Service Mode)" to E-7 "14. Unit change."

## 22. Affixing the labels

Affix the supplied panel sheet to the surface of the operation panel.

**Note:**

- The panel sheet is affixed on customer request.
- The panel sheet must be kept by the customer.

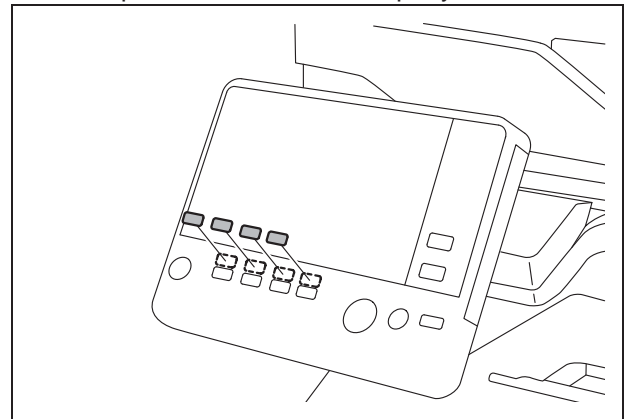

# UK-219 Upgrade Kit

## INSTALLATION MANUAL

### 1. Accessory parts

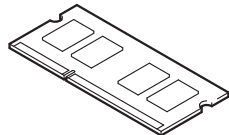
No.	Name	Shape	Q'ty
1.	Memory		1

### WARNING



Keep this bag away from babies and children. Do not use in cribs, beds, carriages, or playpens.



The thin film may cling to nose and mouth and prevent breathing. This bag is not a toy.

#### Note:

- When installing the Fax Kit FK-517 together, this product must be installed first.
- The memory is highly susceptible to static electricity. Before touching the memory be sure to touch a metal object to discharge any static electricity from your body and clothes.
- Never touch any pins or other parts of the circuit board when removing the memory from the insulation bag or inserting it into the socket.
- Before starting to use the firmware updated with this upgrade kit, make sure that the version of the applications and printer driver installed in the machine is compatible with the updated firmware. Check the field support information for version compatibility between the firmware, application, and printer driver.
- When your customer bought i-Option LK-104 v3 (license kit for audio guide function), copy audio guide data from the USB flash drive and install it to the machine. For details on the installation method, see service manual.

- This manual provides the illustrations of the accessory parts and machine that may be slightly different in shape from yours. In that case, instead of the illustrations, use the appearance of your machine to follow the installation procedure. This does not cause any significant change or problem with the procedure.

### 2. Installation procedures

- (1) Turn OFF the power switch and unplug the power cord from the power outlet.
- (2) Open the right door.

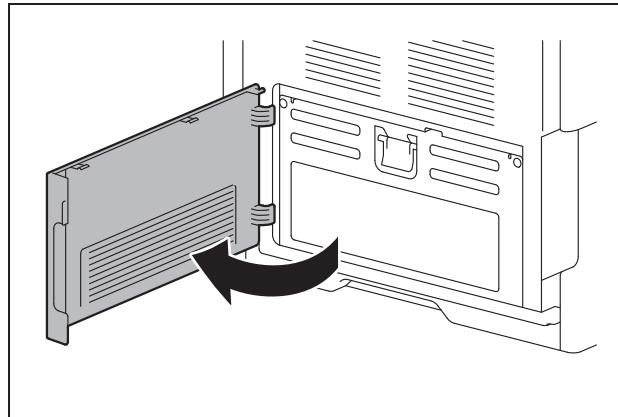

- (3) Lift up the lever, and remove the plate. (Two screws)

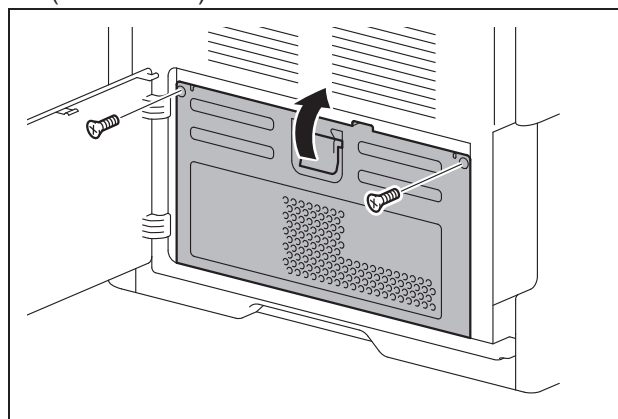

- (4) Insert the memory into the slot shown in the illustration in the MFP board at an angle while paying attention to the insertion direction.

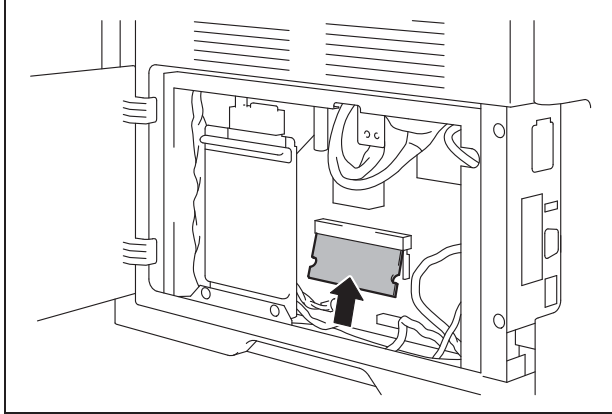

- (5) Press the memory at the position shown in the illustration to install it into the MFP board.

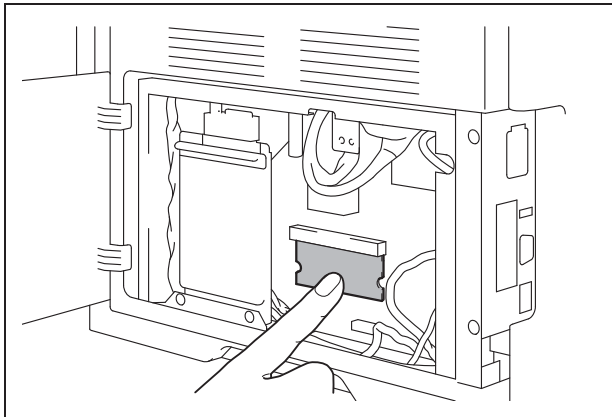

- (6) Attach the plate removed in step (3).  
(Two screws)  
(7) Close the right door.

### 3. Configuration procedures

#### <Check after the memory has been Installed>

- (1) Plug the power cord into the power outlet and turn ON the power switch.
- (2) Display the Service Mode screen.  
(For details of how to display the Service Mode screen, see the service manual.)
- (3) Touch "State Confirmation."
- (4) Touch "Memory/Storage Status."
- (5) Make sure that the volume of memory was increased.
- (6) Touch "END."
- (7) Touch "Exit" on the Service Mode screen.